

abbotFox
Land &
New Homes.



West View

Little Melton, Norfolk, NR9

“An incredibly rare opportunity to self build in a much sought after village overlooking fields and within striking distance of Norwich. Planning permission has been submitted. Offers are invited subject to this application being approved”

Samuel Le Good | Partner



Introduction

An application has been made for outline consent to be granted for the erection of a detached family home approaching 2,500 sq ft with a detached double garage. Confirmation of this planning application and associated documents can be found using South Norfolk Council's planning portal and the reference 2022/1086

Inside

The proposed property will provide generous accommodation approaching 2,500 sq ft which is considered to be a large family home.

Outside

The overall plot extends to approx 0.25 acres (stms) and overlooks fields to the rear (west) and side (east).

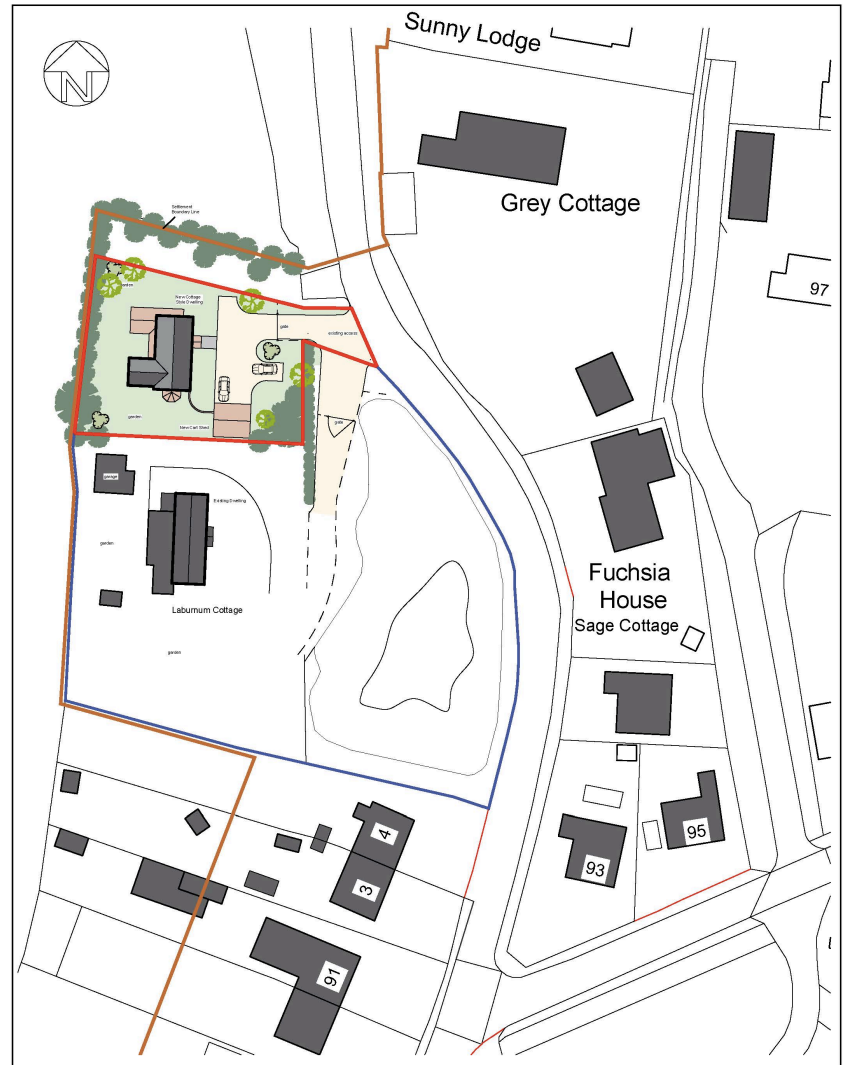

Site Block Plan 1 / 500

Location

Little Melton sits just 5 miles west of the Cathedral city of Norwich and is only 1.5 miles north east of Hethersett and 5.5 miles from the historic market town of Wymondham with a weekly farmers market, wide range of independent shops, coffee shops, restaurants a Waitrose supermarket, two doctors surgeries, pharmacies and dentists. Nearby Hethersett offers a good range of amenities.

Immediately on your doorstep there is a vast network of walks and bridleways through unspoilt Norfolk countryside. The village has a shop and public house/restaurant.

Little Melton has an active village hall.



Families

Local schools include Little Melton's highly regarded primary school. Further schools covering all ages can be found in nearby Hethersett and Wymondham.

Norwich offers a comprehensive range of schools including several private schools.

Little Melton has a playing field and tennis court.





Samuel Le Good | Partner

samuellgood@abbotfox.co.uk | 01603 660000 | 07915 660981 | @samuellgood

Kingsley House
2a Upper King Street
Norwich
NR3 1AH



Disclaimer - In accordance with the Property Mis-descriptions Act, the company gives notice that all descriptions, references to condition, necessary permissions for use and other details are given in good faith and believed to be correct, but any intending lessees do not rely on them statements of fact, but must satisfy themselves by inspection or other means, as to their accuracy